



Value Life



Ports

As vascular access experts, we work closely with clinicians and their patients to ensure that our products combine the ideal dwell time – whether that's short, medium or long-term – with ease of use, effectiveness and value for money.

Our range of ports is specifically designed as totally implantable vascular access devices to deliver secure, long-term intermittent IV therapy.

With a focus on patient comfort during a variety of treatments including chemotherapy, parenteral nutrition, antibiotics, pain management, fluids and blood sampling, our ports' range delivers for both paediatric and adult patients.

Lightweight and safe

The hybrid combination of titanium and POM in our polysite and seesite ports produces a lightweight device that's also safer than a full plastic port. With polysite and seesite there's no risk of particulate formation from the Huber needle scratching the reservoir base. Plus a smooth surface also means less dead space for bacterial ingress.

With the addition of unique radiopaque marking with maximum flow rate and identification in seesite, the port positioning and fluid rate is instantly detectable by X-ray.

Ultimate patient benefits

Where aesthetics and patient comfort are the priorities, our low profile titanium port sitimplant and hybrid port heliosite offer the ideal options.

Perfect placement

All Vygon ports are available with a variety of insertion kit accessories to ensure the right placement is achieved first time using the preferred procedure.

Key

MRI MRI conditional

CT CT compatible



The polysite™ range is sterilised by ethylene oxide. polysite™ is a registered trademark of PEROUSE MEDICAL.

Port selection tool

For patients requiring long-term, intermittent IV therapy.

Choose from standard, mini, micro or low profile implantable ports.

	Standard hybrid port for adults	Mini hybrid port for adults and paediatrics	Low profile hybrid port	Low profile titanium port
	polysite 4000 seesite 4000	polysite3000 seesite 3000	heliosite	sitimplant
Description	Large, lightweight, hybrid port with titanium reservoir and POM casing. Ergonomic shape for ease of insertion into the skin pocket.	Standard, lightweight, hybrid port with titanium reservoir and POM casing. Ergonomic shape for ease of insertion into the skin pocket.	Low profile, hybrid port for best patient comfort and aesthetics. Smooth design for minimal fibrotic adherence for easy removal. Compact silicone casing with click & lock connection system.	Low profile, full titanium port for best patient comfort and aesthetics. Round base for stability.
Flow	325psi max 5mL/s with 19 or 20G CT Huber needle.	325psi max 3mL/s with 20 or 22G CT Huber needle.	350psi max 7mL/s with 9.6Fr catheter and 19G CT Huber needle.	350psi max 7mL/s with 9.6Fr catheter and 19G CT Huber needle.
Suitable for	High BMI patients.	Normal BMI patient. Large paediatrics.	Patients concerned with aesthetic appearance or tissue paper thin skin with risk of port externalisation.	Specific request for a full titanium port.
Material	Titanium & POM	Titanium & POM	Titanium & Silicone	Titanium
Advantages	<ul style="list-style-type: none"> • Lighter than a full titanium port with less risk of port migration • Less expensive than a full titanium port • CT compatible • MRI conditional • Safer than a full plastic port (no risk of particulate formation from huber needle scratching reservoir base. A smooth surface also means less dead space for bacterial ingress). 	<ul style="list-style-type: none"> • Lighter than a full titanium port with less risk of port migration • Less expensive than a full titanium port • CT compatible • MRI conditional • Safer than a full plastic port (no risk of particulate formation from huber needle scratching reservoir base. A smooth surface also means less dead space for bacterial ingress). 	<ul style="list-style-type: none"> • Low profile (good patient comfort and aesthetic appearance) • Less risk of externalisation due to smooth surface • Easy removal due to minimal fibrotic adherence • CT compatible (high pressure & flow up to 7mL/s) • MRI conditional • Easy catheter connection. 	<ul style="list-style-type: none"> • Low profile (good patient comfort and aesthetic appearance) • Lightweight compared to other full titanium ports • CT compatible (high pressure & flow up to 7mL/s) • MRI conditional.
Insertion technique	Surgical, standard MST or long MST kit. US-guided insertion kit with Raulerson blood-loss device (seesite™ only).	Surgical, standard MST or long MST kit. US-guided insertion kit with Raulerson blood-loss device (seesite™ only).	Surgical, or MST with nitinol anti-kink guidewire and BLS valve.	Surgical, or MST with nitinol anti-kink guidewire and BLS valve.
Catheter material	Silicone or PUR catheter	Silicone or PUR catheter	Silicone catheter	Silicone catheter
Catheter Fr	Si - 7.2, 9.5Fr PUR - 6.9, 8, 9Fr	Si - 6.5, 7.2Fr PUR - 6.9Fr	Si - 6.6Fr N/A	Si - 4, 5.1, 6.6, 8.4, 9.6Fr N/A
Connected/preconnected	Catheter preconnected or not preconnected.	Catheter preconnected or not preconnected.	Catheter preconnected or not preconnected.	Catheter preconnected or not preconnected.
Radiopacity	Unique radiopaque marking with max flow rate identification (seesite™ only).	Unique radiopaque marking with max flow rate identification (seesite™ only).	N/A	N/A

polysite™ 4000

Ports for adult patients

Standard hybrid construction with titanium and POM⁽¹⁾

MRI

CT

- Profile-shaped design
- Easy to connect
- Titanium-POM⁽¹⁾ combination: low weight
- Titanium reservoir: compatible with antineoplastic agents
- Radiopaque connecting ring
- MRI conditional⁽²⁾ & CT compatible

Max 325psi
& 5mL/s with
19G or 20G
CT Huber
needle

Port features

Port type	Adult	Septum diameter	12.1mm
Materials	POM ⁽¹⁾ + titanium	Weight	7.6g
Base diameter	30.8 x 22.6mm	Port height	12.2mm

4 1 0 8 ISP

ISP: Peel-away sheath introducer

4: 4000 series

1: preconnected

0: not preconnected

1: polyurethane catheter

0: silicone catheter

8: 8Fr introducer

seesite™ 4000 series

Unique and innovative radiopaque marking

- Radiopaque marking detectable by X-ray
- Silicone filled suture holes
- Each graduation = 1 mL/s
- Radiopaque connecting ring
- Easy to check correct positioning

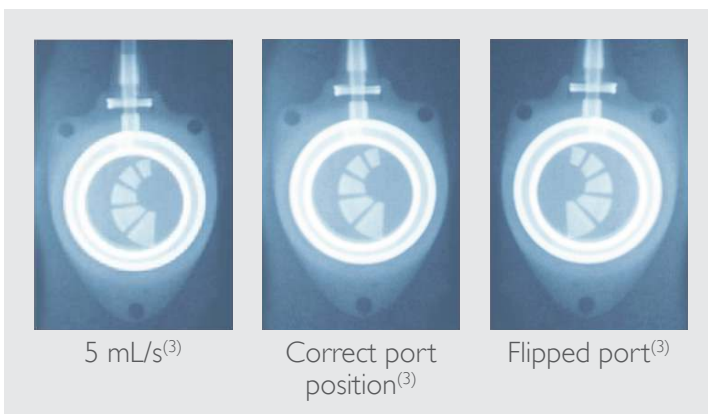

(1) Polyoxymethylene. (2) See polysite & Seesite IFUs. (3) Non contractual pictures.
The polysite™ range is sterilised by ethylene oxide. polysite™ is a registered trademark of PEROUSE MEDICAL.

Silicone catheters

Vygon codes	Insertion kit	Kit number (see page 11)	Introducer sheath (Fr)	Catheter size (Fr)	Length (cm)	Preconnected catheter
VPE4008	Surgical	2	8	7.2	60	No
VPE4108	Surgical	2	8	7.2	60	Yes
VPE40010	Surgical	2	10	9.5	60	No
VPE41010	Surgical	2	10	9.5	60	Yes
VPE4008ISP	MST	4	8	7.2	60	No
VPE4108ISP	MST	4	8	7.2	60	Yes
VPE40010ISP	MST	4	10	9.5	60	No
VPE41010ISP	MST	4	10	9.5	60	Yes
VPE4008SEE	seesite	6	8	7.2	60	No
VPE4108SEE	seesite	6	8	7.2	60	Yes
VPE40010SEE	seesite	6	10	9.5	60	No
VPE41010SEE	seesite	6	10	9.5	60	Yes

Polyurethane catheters

Vygon codes	Insertion kit	Kit number (see page 11)	Introducer sheath (Fr)	Catheter (Fr)	Length (cm)	Preconnected catheter
VPE4017	Surgical	2	7	6.9	60	No
VPE4117	Surgical	2	7	6.9	60	Yes
VPE4018	Surgical	2	8	8	60	No
VPE4118	Surgical	2	8	8	60	Yes
VPE4019	Surgical	2	9	9	60	No
VPE4119	Surgical	2	9	9	60	Yes
VPE4017ISP	MST	4	7	6.9	60	No
VPE4117ISP	MST	4	7	6.9	60	Yes
VPE4018ISP	MST	4	8	8	60	No
VPE4118ISP	MST	4	8	8	60	Yes
VPE4019ISP	MST	4	9	9	60	No
VPE4119ISP	MST	4	9	9	60	Yes
VPE4018SEE	seesite	6	8	8	60	No
VPE4118SEE	seesite	6	8	8	60	Yes
VPE4019SEE	seesite	6	9	9	60	No
VPE4119SEE	seesite	6	9	9	60	Yes

polysite™ 3000

Ports for adults and paediatric patients

Standard hybrid construction with titanium and POM

MRI

CT

- Profile-shaped design
- Easy to connect
- Titanium-POM⁽¹⁾ combination: low weight
- Titanium reservoir: compatible with antineoplastic agents
- Radiopaque connecting ring
- MRI conditional⁽²⁾ & CT compatible

Max 325psi
& 3mL/s with
20G or 22G
CT Huber
needle

Port features

Port type	Adult	Septum diameter	10.5mm
Materials	POM ⁽¹⁾ + titanium	Weight	5.0g
Base diameter	25.8 x 20.9mm	Port height	10.1mm

3 1 0 7 ISP

ISP: Peel-away sheath introducer

3: 3000 series

1: preconnected

0: not preconnected

1: polyurethane catheter

0: silicone catheter

7: 7Fr introducer

seesite™ 3000 series

Unique and innovative radiopaque marking

- Radiopaque marking detectable by X-ray
- Silicone filled suture holes
- Each graduation = 1 mL/s
- Radiopaque connecting ring

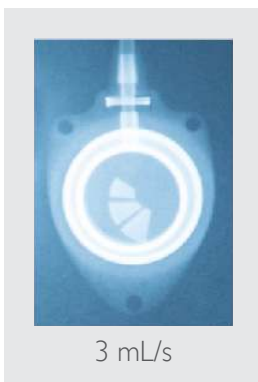

(1) Polyoxymethylene. (2) See IFU.

The polysite™ range is sterilised by ethylene oxide. polysite™ is a registered trademark of PEROUSE MEDICAL.



Silicone catheters

Vygon codes	Insertion kit	Kit number (see page 11)	Introducer sheath (Fr)	Catheter size (Fr)	Length (cm)	Preconnected catheter
VPE3007	Surgical	2	7	6.5	60	No
VPE3107	Surgical	2	7	6.5	60	Yes
VPE3008	Surgical	2	8	7.2	60	No
VPE3108	Surgical	2	8	7.2	60	Yes
VPE3007ISP	MST	4	7	6.5	60	No
VPE3107ISP	MST	4	7	6.5	60	Yes
VPE3008ISP	MST	4	8	7.2	60	No
VPE3108ISP	MST	4	8	7.2	60	Yes
VPE3007SEE	seesite	6	7	6.5	60	No
VPE3107SEE	seesite	6	7	6.5	60	Yes
VPE3008SEE	seesite	6	8	7.2	60	No
VPE3108SEE	seesite	6	8	7.2	60	Yes

Polyurethane catheters

Vygon codes	Insertion kit	Kit number (see page 11)	Introducer sheath (Fr)	Catheter (Fr)	Length (cm)	Preconnected catheter
VPE3017	Surgical	2	7	6.9	60	No
VPE3117	Surgical	2	7	6.9	60	Yes
VPE3017ISP	MST	4	7	6.9	60	No
VPE3117ISP	MST	4	7	6.9	60	Yes
VPE3017SEE	seesite	6	7	6.9	60	No
VPE3117SEE	seesite	6	7	6.9	60	Yes

polysite™ 2000

Ports for paediatric patients and brachial placement

Standard hybrid construction with titanium and POM⁽¹⁾



- Good stability
- Minimum weight
- Flat lateral edges for good adherence
- Non-traumatic angle
- Radiopaque connecting rings
- Titanium reservoir: compatible with antineoplastic agents
- MRI conditional⁽²⁾ & CT compatible

Max 325psi
& 1mL/s with
20G or 22G
CT Huber
needle

Port features

Port type	Paediatric or adult	Septum diameter	7.8mm
Materials	POM ⁽¹⁾ + titanium	Weight	2.9g
Base diameter	22.0 x 17.0mm	Port height	8.7mm

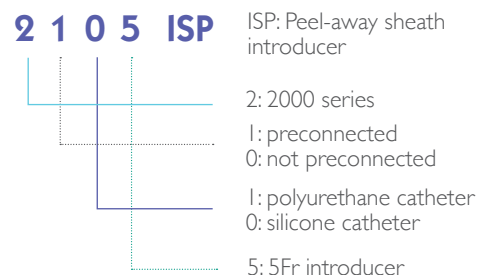

seesite™ 2000 series

Unique and innovative radiopaque marking

- Radiopaque marking detectable by X-ray
- Silicone filled suture holes
- Each graduation = 1 mL/s
- Radiopaque connecting ring

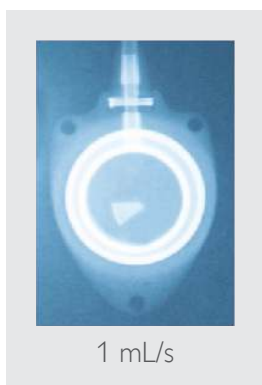

(1) Polyoxymethylene, (2) See I.F.U.

The polysite™ range is sterilised by ethylene oxide, polysite™ is a registered trademark of PEROUSE MEDICAL.

Silicone catheters

Vygon codes	Insertion kit	Kit number (see page 11)	Introducer sheath (Fr)	Catheter size (Fr)	Length (cm)	Preconnected catheter
VPE2005	Surgical	2	5	5	60	No
VPE2105	Surgical	2	5	5	60	Yes
VPE2007	Surgical	2	7	6.5	80	No
VPE2107	Surgical	2	7	6.5	80	Yes
VPE2005ISP	MST	3	5	5	60	No
VPE2105ISP	MST	3	5	5	60	Yes
VPE2007ISP	MST	4	7	6.5	80	No
VPE2107ISP	MST	4	7	6.5	80	Yes
VPE2005SEE	seesite	5	5	5	60	No
VPE2105SEE	seesite	5	5	5	60	Yes

Polyurethane catheters

Vygon codes	Insertion kit	Kit number (see page 11)	Introducer sheath (Fr)	Catheter (Fr)	Length (cm)	Preconnected catheter
VPE2015	Surgical	2	5	5	60	No
VPE2115	Surgical	2	5	5	60	Yes
VPE2016	Surgical	2	6	6	80	No
VPE2116	Surgical	2	6	6	80	Yes
VPE2015ISP	MST	3	5	5	60	No
VPE2115ISP	MST	3	5	5	60	Yes
VPE2016ISP	MST	4	6	6	80	No
VPE2116ISP	MST	4	6	6	80	Yes

polysite™ and seesite™ kit composition

Insertion kit accessories

For surgical technique:

polysite™

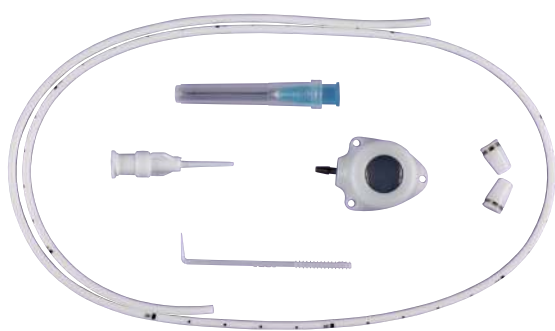

For Modified Seldinger technique:

polysite™ ISP



For Modified Seldinger and US-guided venipuncture technique:

seesite™

Includes safety Huber needle, echogenic puncture needle and Raulerson device.



In addition to the accessories all kits contain: an implantable port, a radiopaque catheter and two connection rings (only one for preconnected references).

The polysite™ range is sterilised by ethylene oxide. polysite™ is a registered trademark of PEROUSE MEDICAL.

Technique	Surgical	Modified Seldinger (ISP)			For Modified Seldinger and US-guided venipuncture technique	
		2	3	4	5	6
Kit						
Straight Huber needle	22G	22G	22G	22G	22G	22G
Vein pick	Yes	Yes	Yes	Yes	Yes	Yes
Flushing device preconnected to the catheter (only for non preconnected references)	Yes	Yes	Yes	Yes	Yes	Yes
Peelable introducer	-	12cm	17cm	12cm	17cm	
J guidewire marked every 10cm	-	0.018"/40cm	0.035"/60cm	-	-	
Puncture needle	-	-	-	0.018"/40cm	0.035"/60cm	
Tunneling device	-	Ø2mm / 18cm	Ø2.5mm / 23cm	Ø2mm / 18cm	Ø2.5mm / 23cm	
Syringe	-	10mL	10mL	10mL	10mL	
Raulerson device	-	-	-	Yes	Yes	
Civ-Flex™ (Probe sheath, elastic bands, gel)	-	-	-	Yes	Yes	
Safety Huber needle compatible with pressure injection PPS™ CT	-	-	-	22G / 20mm	20G / 20mm	

sitimplant™

Low profile titanium port

MRI

CT

- Full titanium: robust and durable
- Low profile for best patient comfort and aesthetics
- Easy septum location by palpation
- Round base for stability
- MRI conditional⁽¹⁾ & CT compatible

Max 350psi
& 7mL/s with
9.6F cat & 19G
CT Huber
needle



Micro



Mini



Standard

Three sizes: adapted to any patient morphology

Vygon codes				Port sizes	Dimensions (base ØxH) (mm)	Septum diameter (mm)	Weight (g)	Catheter (Fr)	Pre-connected catheter
Surgical	Modified Seldinger kit								
Kit (see page 15)									
1	2	3	4						
00221171	-	-	-	Micro	19 x 8	8	3.5	4	No
-	2211.77	-	-					4	No
-	2211.78	-	-					4	Yes
00221191	-	-	-					5.1	No
00221161	-	-	-					6.6	No
-	-	2211.67	-					6.6	No
-	-	2211.68	-					6.6	Yes
002215014	-	-	-					4	No
002215024	-	-	-	4	Yes				
-	-	-	002215125	Mini	24 x 10	10	8	5.1	Yes
002215016	-	-	-					6.6	No
-	-	002215116	-					6.6	No
002215026	-	-	-					6.6	Yes
-	-	002215126	-					6.6	Yes
002215017	-	-	-					8.4	No
-	-	002215117	-					8.4	No
002215019	-	-	-					9.6	No
-	-	002215119	-					9.6	No
-	-	002215129	-					9.6	Yes
2216.016	-	-	-	Standard	28 x 11	13	10.5	6.6	No
-	-	002216116	-					6.6	No
002216026	-	-	-					6.6	Yes
-	-	002216126	-					6.6	Yes
002216017	-	-	-					8.4	No
-	-	002216117	-					8.4	No
002216019	-	-	-					9.6	No
-	-	002216119	-					9.6	No
002216029	-	-	-					9.6	Yes
-	-	002216129	-					9.6	Yes

(1) See IFU.

heliosite™

Low profile titanium port



- Hybrid: titanium and compact silicone
- Low profile for best patient comfort and aesthetics
- Smooth design for minimal fibrotic adherence
- Highly biocompatible compact silicone casing
- Click and lock connection system
- MRI conditional⁽¹⁾ & CT compatible

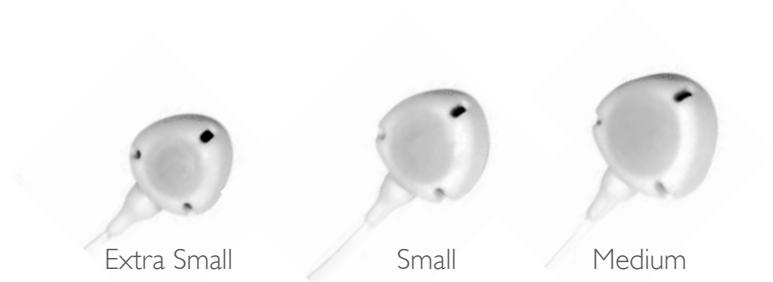

Three sizes: adapted to any patient morphology

Vygon codes	Kit number (see page 15)	Port sizes	Dimensions (base ØxH) (mm)	Septum diameter (mm)	Weight (g)	Catheter (Fr)	Pre- connected catheter
002217116	4	XS	23 x 9	8	5	6.6	No
002217126	4						Yes
002218116	4	S	25 x 10	10	6.3	6.6	No
002218126	4						Yes
002219116	4	M	27 x 11	12	8	6.6	No
002219126	4						Yes

sitimplant™ and heliosite™ kit composition

Insertion kit accessories

For surgical technique:

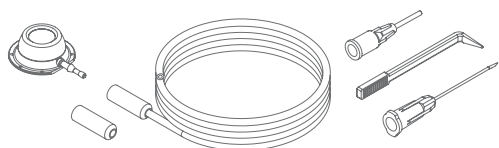

In addition to the accessories all kits contain: an implantable port, a radiopaque catheter and two connection rings (only one for preconnected references).

For Modified Seldinger technique:

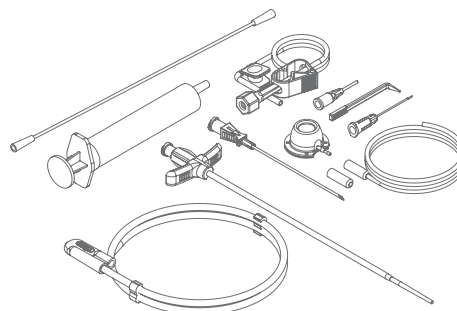

Benefits of the accessories included in the Modified Seldinger kit:

Peelable sheath

- Rigid enough to pass through the skin without kinking and flexible enough to move easily along the vein

Nitinol guidewire

- Kink-resistant, easy reading of inserted length

Bloodless system valve

- Prevents blood spillage and air embolism

Needle

- Best puncture properties and echogenic

Technique	Surgical kit		Modified Seldinger kit		
Kit	1	2	3	4	
Straight Huber needle	22G / 25mm	22G / 25mm	22G / 25mm	22G / 25mm	
Flushing device	Yes	Yes	Yes	Yes	
Vein pick	Yes	Yes	Yes	Yes	
Peelable introducer	-	7cm	14cm	14cm	
Nitinol J guidewire, marked every 10 cm with thumbfeed advancer	-	0.021" - 30cm	0.035" - 53cm	0.035" - 53cm	
Puncture needle with BLS valve	-	20G - 38mm	18G - 68mm	18G - 68mm	
Tunneling device	-	2.5mm x 23cm	3.0mm x 23cm	2.5mm x 23cm	
Syringe	-	10mL	10mL	10mL	
Huber needle with connecting line: hubsite™	-	22G - 20mm	20G - 20mm	20G - 20mm	

Why Vygon?

Complementing our comprehensive ports' range is Vygon's expertise in vascular access training and education. We prioritise the development of our learning resources and up-to-date information, which we consider vital in supporting you and your patients.

Training & education to suit you

We offer a variety of training options ranging from local sessions facilitated by your Sales Executive to peer led study days and workshops with our Clinical Nurse Advisors with plenty of options to gain 'hands-on' experience.

With careers that have seen them excel in their healthcare professions, our Clinical Nurse Advisors are ideally placed to provide an appreciation and understanding of the practicalities of vascular access and to share that knowledge. As authors of published peer-reviewed papers and regular participants in prominent National and International IV organisations and forums, they are at the ideal partners to support you with delivering best practice.

Our regional workshops provide an in-depth training session on device insertion, care and maintenance. The course will take you through anatomy and physiology, device selection, insertion best-practice plus care and maintenance in line of devices with National guidelines. These sessions include the use of hands-on training aids and manikins so that you can be declared competent in the use of the product in a simulated environment. You can then return to your hospital ready to be supervised and declared competent in a clinical setting by your hospital training teams and by our Clinical Nurse Advisors.



For further information, please contact: vygon@vygon.co.uk

The specifications shown in this leaflet are for information only and are not, under any circumstances, of a contractual nature.

Vygon (UK) Ltd, The Pierre Simonet Building, V Park, Gateway North,
Latham Road, Swindon, Wiltshire SN25 4DL

Tel: 01793 748800 Fax: 01793 748899 Email: vygon@vygon.co.uk

vygon.co.uk [@vygonuk](https://twitter.com/vygonuk) [in](https://www.linkedin.com/company/vygonuk) vygonuk [yt](https://www.youtube.com/channel/UCvYgONk) vygonuk [ig](https://www.instagram.com/vygonuk) vygonuk

Copyright Vygon (UK) Ltd 2020 Content correct as of: 03/2020 Code: DXJB0004017V00194 v1



Value Life